



# The Clown fish (age 3-12 years)

Ref. KZM1004

Last check oct./2019

Pág. 3/3

EN-1176-1: 1/7



SERIE  
**ANIMALS**  
SERIES

*special projects*

## Technical Information:

**Animal:** Build in polyester painted by mass, with gel-coat of predominant colour and anti-graffiti treatment.

**Structure:** Internal build in galvanized steel pipe.

**Surface:** Steppable zone realized in high resistance continuous wet-pour rubber surfacing (EPDM).

**Swing Chain:** Made of galvanized Steel.

**Swing seat:** Made of injected rubber with aluminum core.

**Climbing Stones:** manufactured in ultimate generation polyurethane with rough finish.

**Slide:** Made of fiberglass reinforced polyester.

**Fasteners:** Zinc-plated steel.

**Anchoring:** fixings in polyester with glass fiber reinforcement for screwing on concrete slab.



C/ Foia, 13  
P.I. Alqueria  
de Moret  
46210 Picanya  
(Valencia)



+34 963 313 677



@ kiwi@kiwipw.com



kiwiplaygrounds.com

The company reserves  
the right to perform  
any modification or  
change in their products.



THEMED AREAS

MULTIGAMES



# The Clown fish (age 3-12 years)

Ref. KZM1004

Last check oct./2019

Pág. 3/3

EN-1176-1: 1/7



SERIE  
**ANiMALS**  
SERIES

*special projects*

Maximum dimensions (m.)

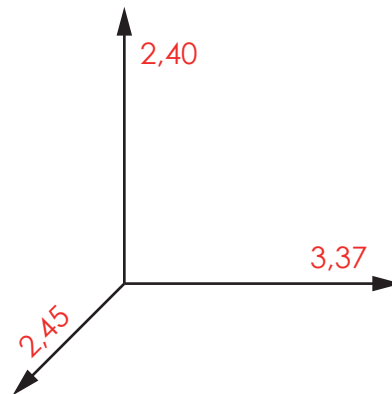

**Technical data:**

**Assembly:** 4 pers. 4 hours.

**Total high:** 2,40 m.

**Free fall height:** 1,50 m.

**Dimensions:** 3,37 x 2,45 x h2,4 m.

**Safety area:** 65 m<sup>2</sup>

**Biggest element dimensions:** 3,40 m.

**Spare parts disponibility:** 3 years.

Total safety area: 65 m<sup>2</sup>

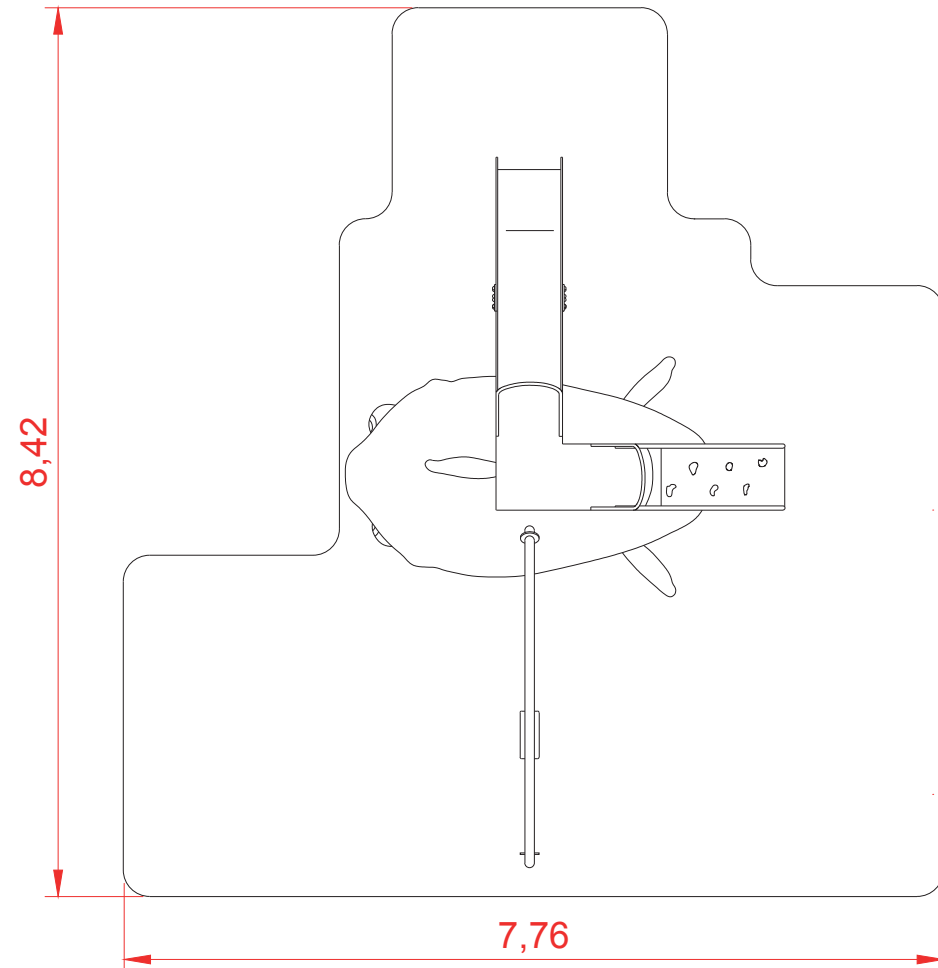

MULTIGAMES THEMED AREAS



C/ Foia, 13  
P.I. Alqueria  
de Moret  
46210 Picanya  
(Valencia)



+34 963 313 677



kiwi@kiwipw.com



kiwipw.com

The company reserves  
the right to perform  
any modification or  
change in their products.



# The Clown fish (age 3-12 years)

Ref. KZM1004

Last check oct./2019

Pág. 3/3

EN-1176-1: 1/7



SERIE  
**ANiMALS**  
SERIES

*special projects*



C/ Foia, 13  
P.I. Alqueria  
de Moret  
46210 Picanya  
(Valencia)



+34 963 313 677



kiwi@kiwipw.com



kiwipw.com

The company reserves  
the right to perform  
any modification or  
change in their products.

Foundation dimensions.

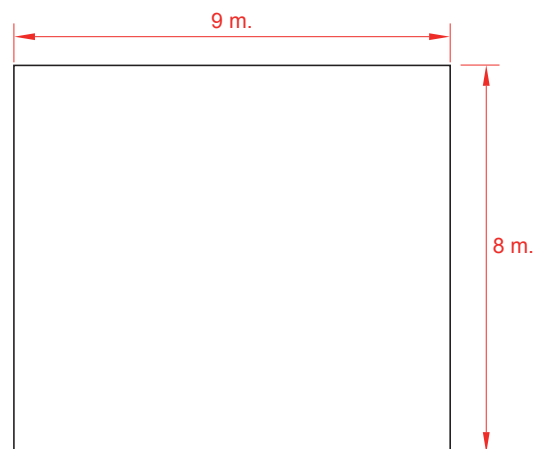

## Installation.

Anchored to the floor with expansion bolts. Finished with compacted material coating either continuous wet-pour rubber surfacing or rubber tiles.

## Maintenance.

-Check: All fixing points. Screws and bolts must be periodically checked, then tightened and adjusted if necessary. The checking date must be annotated in order to establish a control.

## Inspections.

-Routine Inspection: A visual and functional inspection must be carried out every 3 months in order to check that the module has suffered no harm due to vandalism or mishandling.

-Yearly Inspection: A full inspection of the entire installation must be done to check that it keeps all norm standards and has suffered no alterations.

Anchoring detail

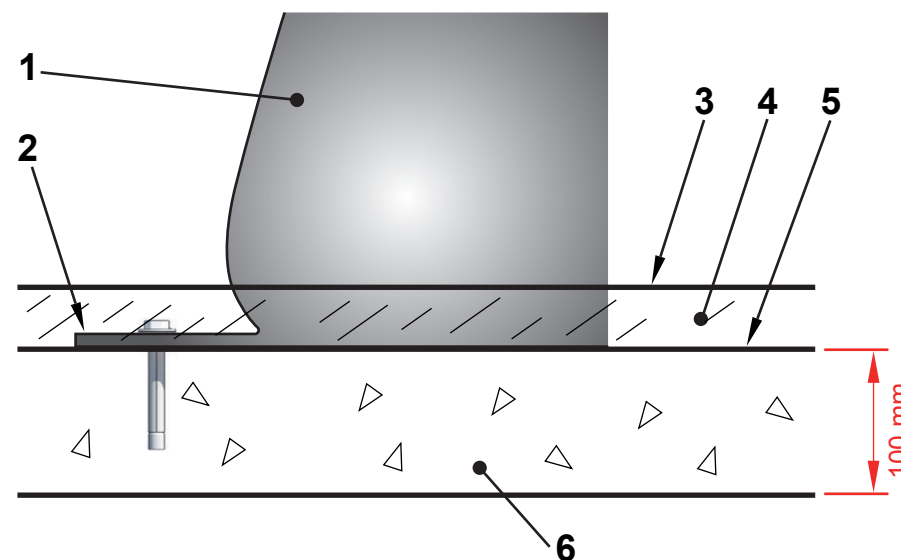

1 Animal.  
2 Tab.  
3 Playing surface.

4 Rubber.  
5 Foundation's upper layer.  
6 Foundation.

MULTIGAMES THEMED AREAS