



Climbing Wall - consonants (age 3-6 years)

Ref. KP1039

Last check dec./ 2018

Pag. 1/3

EN-1176-1: 1/7



SERIE
ANIMALS
SERIES

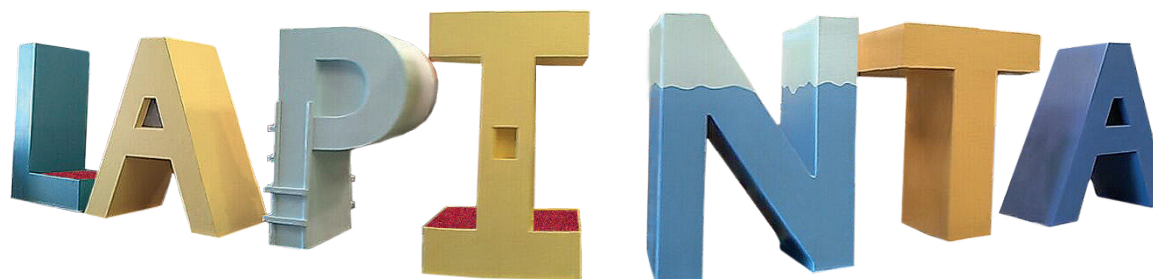

Technical information.

Structure: Made of water repellent wood board.

Finish: exterior lined in fiberglass sheets with polyphonic coating and mass painted with color to choose.

Climbing holds: Made in latest generation polyurethane with rugged finish.

Screws: of zinc plates steel.

Bindings: High resistance angle brackets made in zinc plates steel.

Technical data.

Assembly: 2 pers. 2 hours.

Total high: 2 m.

Maximum height fall: 2 m.

Safety area: 26,8 m²

Biggest piece dimension: 2 m.

Spare pieces availability: 3 years.

You can compose any word, combining references KP1038 and KP1039, and with or without climbing holds.



C/ Foia, 13
P.I. Alquería
de Moret
46210 Picanya
(Valencia)



+34 963 313 677



kiwi@kiwipw.com



www.kiwipw.com

The company reserves
the right to perform
any modification or
change in their products.

CLIMBING WALLS



Climbing Wall - consonants (age 3-6 years)

Ref. KP1039

Last check dec./ 2018

Pag. 2/3

EN-1176-1: 1/7



SERIE
ANIMALS
SERIES

Safety area: 26,8 m²
(It varies depending
on the letter.)

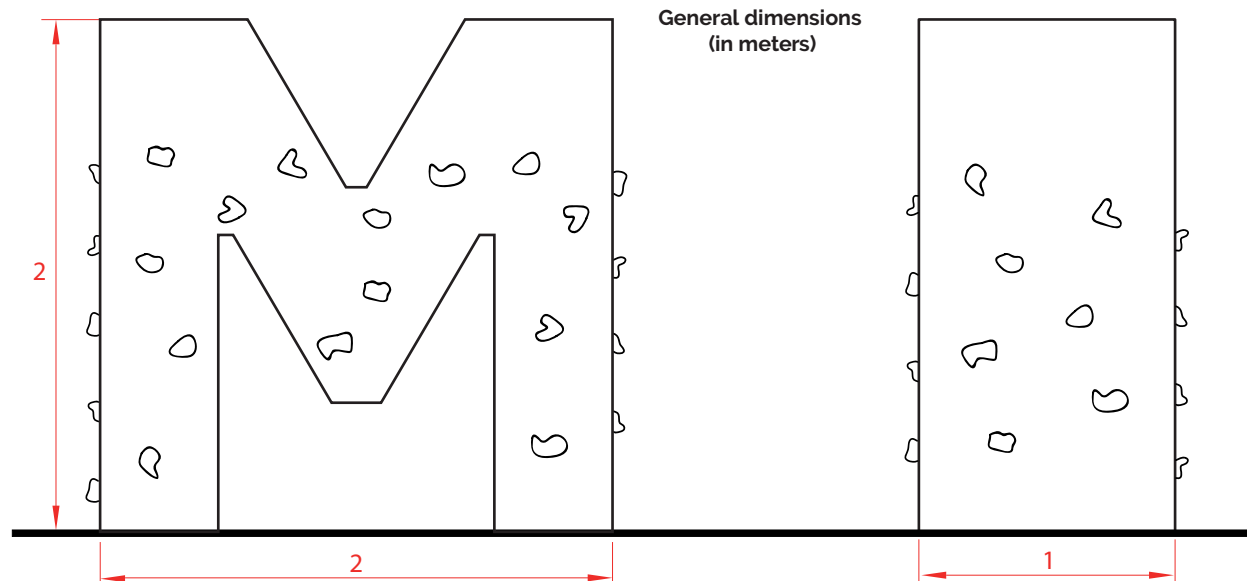
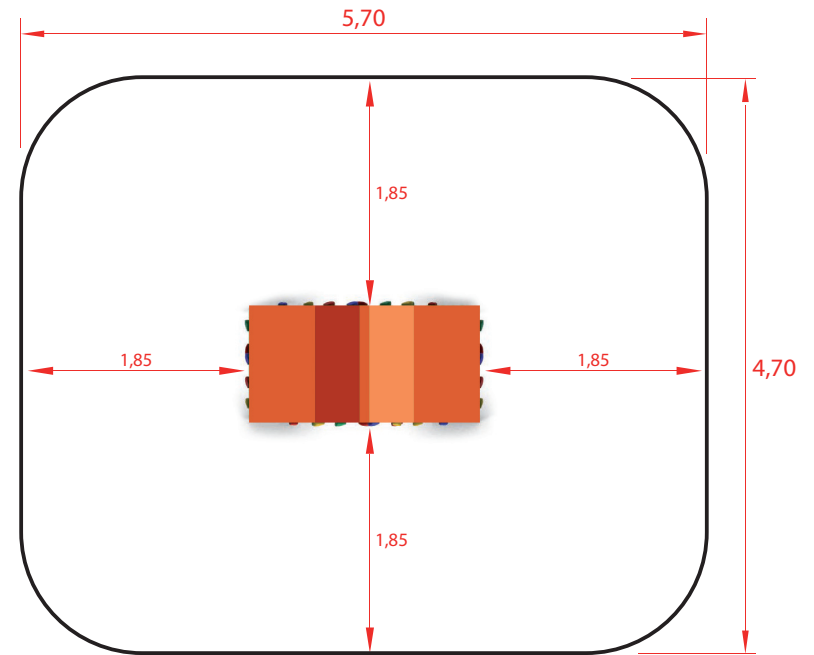

General dimensions
(in meters)

CLIMBING WALLS



C/ Foia, 13
P.I. Alquería
de Moret
46210 Picanya
(Valencia)



+34 963 313 677



kiwi@kiwipw.com



www.kiwipw.com

The company reserves
the right to perform
any modification or
change in their products.



Climbing Wall - consonants (age 3-6 years)

Ref. KP1039

Last check dec./ 2018

Pag. 3/3

EN-1176-1: 1/7



SERIE
ANIMALS
SERIES

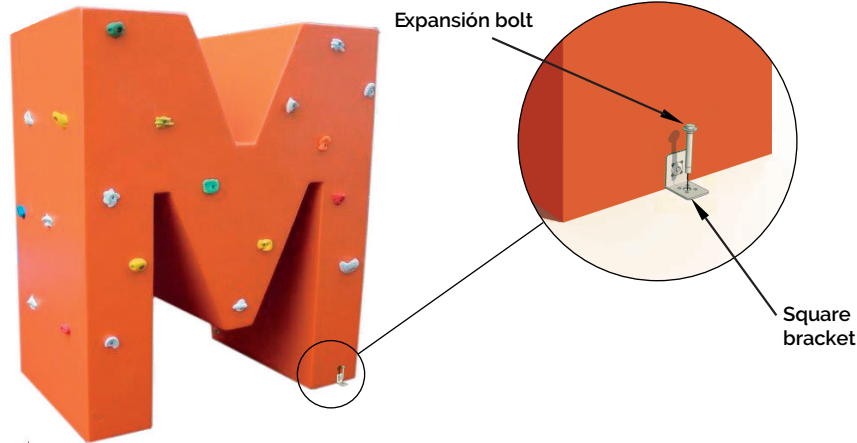

Installation.

Anchored to the floor with expansion bolts. Finished with compacted material coating either continuous wet-pour rubber surfacing or rubber tiles.

Maintenance.

-Check: All fixing points. Screws and bolts must be periodically checked, then tightened and adjusted if necessary. The checking date must be annotated in order to establish a control.

Inspections.

-Routine Inspection: A visual and functional inspection must be carried out every 3 months in order to check that the module has suffered no harm due to vandalism or mishandling.

-Yearly Inspection: A full inspection of the entire installation must be done to check that it keeps all norm standards and has suffered no alterations.



C/ Foia, 13
P.I. Alquería
de Moret
46210 Picanya
(Valencia)



+34 963 313 677



kiwi@kiwipw.com



www.kiwipw.com

The company reserves
the right to perform
any modification or
change in their products.

Dimensions for the concrete slab.
It varies depending on the letter.

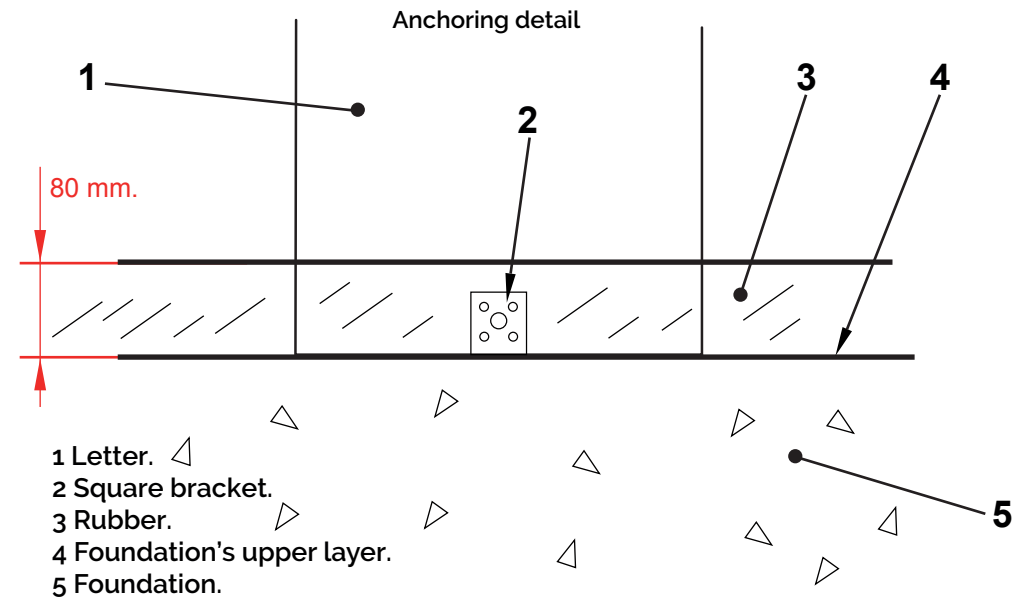

CLIMBING WALLS